

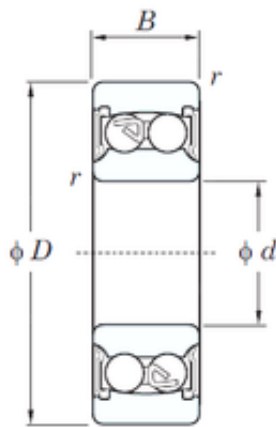

BEARING SUDAMERICANA, S.A.

50 mm x 110 mm x 40 mm KOYO 2310-2RS
self aligning ball bearings



Bearing No. 2310-2RS

Size	50x110x40 mm
Bore Diameter	50 mm
Outer Diameter	110 mm
Width	40 mm
d	50 mm
D	110 mm
B	40 mm
C	40 mm
r min.	2 mm
da min.	60 mm
da max	62.5 mm
Da max.	100 mm
ra max.	2 mm
Weight	1.64 Kg
Basic dynamic load rating (C)	43.4 kN
Basic static load rating (C0)	14.1 kN
(Grease) Lubrication Speed	3700 r/min
Calculation factor (e)	0.23
Calculation factor (Y0)	2.83
Calculation factor (Y1)	2.70

2310-2RS Bearing 2D drawings and 3D CAD models